

1
2005

Proposed ground floor plan
1:200

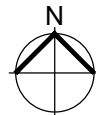

Key:

1. Refer to drawings
243442-PUR-01-XX-DR-A-3700 and
243442-PUR-01-XX-DR-A-3701 for:
Conservation Repairs & Works to Tower
Bridge Arch 01 South Window and Doors
Exterior View and Interior View
2. Refer to drawings
243442-PUR-01-XX-DR-A-3702 and
243442-PUR-01-XX-DR-A-3703 for:
Conservation Repairs & Works to Tower
Bridge Arch 01 West Window Exterior View
and Interior View
3. Refer to drawings
243442-PUR-01-XX-DR-A-3704 and
243442-PUR-01-XX-DR-A-3705 for:
Conservation Repairs & Works to Tower
Bridge Arch 02 West Window Exterior View
and Interior View
4. Refer to drawings
243442-PUR-01-XX-DR-A-3706 and
243442-PUR-01-XX-DR-A-3707 for:
Conservation Repairs & Works to Tower
Bridge Arch 03 West Window Exterior View
and Interior View
5. Refer to drawings
243442-PUR-01-XX-DR-A-3708 and
243442-PUR-01-XX-DR-A-3709 for:
Conservation Repairs & Works to Tower
Bridge Arch 04 West Window Exterior View
and Interior View
6. Refer to drawings
243442-PUR-01-00-DR-A-2120,
243442-PUR-01-00-DR-A-2130 and
243442-PUR-01-00-DR-A-2150 for:
Conservation Repairs & Works to Historic
Fabric: Tower Bridge Arch 01 Internal and
External Elevations
7. Refer to drawings
243442-PUR-01-00-DR-A-2220 and
243442-PUR-01-00-DR-A-2250 for:
Conservation Repairs & Works to Historic
Fabric: Tower Bridge Arch 02 Internal and
External Elevations
8. Refer to drawings
243442-PUR-01-00-DR-A-2320,
243442-PUR-01-00-DR-A-2330 and
243442-PUR-01-00-DR-A-2150 for:
Conservation Repairs & Works to Historic
Fabric: Tower Bridge Arch 03 Internal and
External Elevations
9. Refer to drawings
243442-PUR-01-00-DR-A-2420 and
243442-PUR-01-00-DR-A-2450 for:
Conservation Repairs & Works to Historic
Fabric: Tower Bridge Arch 04 Internal and
External Elevations

Notes:

Drawings are based on survey data and may not accurately represent what is physically present.

Do not scale from this drawing. All dimensions are to be verified on site before proceeding with the work.

All dimensions are in millimetres unless noted otherwise.

Purcell shall be notified in writing of any discrepancies.

All digital information within this DWG format file is the copyright of Purcell Architecture Limited and is for information purposes only. No digital information maybe reused or reproduced by any party for any purpose without written permission.

Key Plan
not to scale

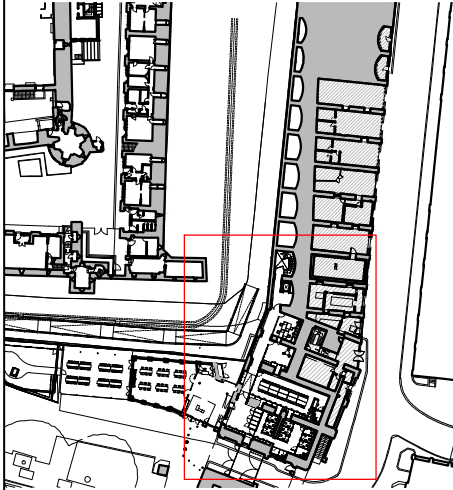

Key

Not in Scope

P05	17.10.2025	RP	KSH	TENDER DRAFT
P04	18.07.2025	KSH	JMcK	STAGE 4 - FOR APPROVAL
P03	27.06.2025	KSH	JMcK	STAGE 4B - FOR INFORMATION
P02	13.06.2025	KSH	JMcK	STAGE 4B - FOR INFORMATION
P01	08.04.2025	KSH	JMcK	FOR INFORMATION
REV	DATE	BY	CHK	DESCRIPTION

CLIENT

Historic Royal Palaces

PROJECT

**Tower of London Education
Facilities**

JOB NUMBER

243442

TITLE

**Conservation Repairs and Works -
Proposed Wharf Level Call-out Plan**

SIZE SCALE
A3L 1:200

REV SUITABILITY/REASON FOR ISSUE
P05 S4 - FOR APPROVAL

DRAWING NUMBER
243442-PUR-01-00-DR-A-2005

PURCELL® IS THE REGISTERED TRADE NAME FOR PURCELL ARCHITECTURE LTD AND ALL SUBSIDIARY COMPANIES AND IS REGISTERED IN THE UNITED KINGDOM, EUROPEAN UNION, HONG KONG, CHINA AND AUSTRALIA.
© PURCELL 2025. www.purcella.com

